



**PR**  
PROPERTY

**8a Thornhill Road, Luton, Bedfordshire, LU4 8EY**  
**£1,000**

- Exclusive to PR Property Lettings
- Parking
- Open Plan Living

- Available Now
- 2 Bedrooms
- Close to L&D Hospital

- Modern Apartment
- Great Location
- Great Transport links

\*\*\* EXCLUSIVE PR PROPERTY LETTINGS \*\*\* TWO BEDROOM APARTMENT \*\* MODERN FINISH THROUGHOUT \*\*\* ALLOCATED PARKING \*\*\* FITTED KITCHEN \*\*\* AVAILABLE NOW \*\*\* OPEN PLAN LIVING SPACE \*\*\* MUST BE VIEWED \*\*\* This property benefits from accommodation comprising of entrance hall, kitchen/living area, two bedrooms and bathroom. Property is on the second floor.

#### HALL

Storage cupboard, double door, door to:

#### LIVING ROOM

Window to rear, door to:

#### BEDROOM 1

Window to rear, door to:

#### BEDROOM 2

Window to front, door to:

#### BATHROOM

Window to front, door.

#### Second Floor

Approx. 49.9 sq. metres (536.8 sq. feet)

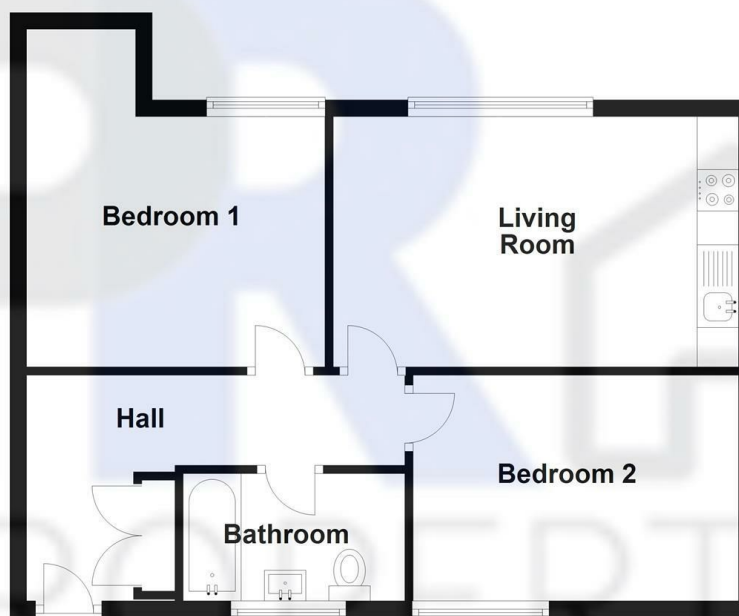

Total area: approx. 49.9 sq. metres (536.8 sq. feet)

8a Thornhill Road, Luton

Energy Efficiency Rating		Current	Potential
Very energy efficient - lower running costs			
(92 plus)	A		
(81-91)	B		
(69-80)	C		
(55-68)	D	65	65
(39-54)	E		
(21-38)	F		
(1-20)	G		
Not energy efficient - higher running costs			
England & Wales		EU Directive 2002/91/EC	